

ABELL SURVEYING & MAPPING

1140 SEQUOIA STREET • DELAVAN, WISCONSIN 53115
262-728-6737

DELANAN LAKE
LAKE ELEVATION 928.08' MARCH 23, 2007

ELEVATION INFORMATION PROVIDED BY USGS
NATIONAL WATER INFORMATION SYSTEM AND
THE DELAVAN LAKE SANITARY DISTRICT.

NOTE: BEARINGS ARE REFERENCED TO
EXISTING SURVEY RECORDS.



SCALE 1"=30'
LEGEND

- △ - IRON PIPE FOUND
- △ - UTILITY POLE
- △ - UTILITY POLE ANCHOR
- - OVERHEAD UTILITY LINES
- - WOOD FENCE
- ⊙ - MANHOLE COVER
- 955|9 - SPOT ELEVATION
- () - RECORDED AS

SEE DETAIL BELOW FOR
HOUSE DIMENSIONS

TOPOGRAPHIC SURVEY OF

A PART OF LOTS 3 AND 6 OF THE SUBDIVISION OF LOT 1 OF METTOWEE, ACCORDING TO A PLAT THEREOF OF RECORD IN THE OFFICE OF THE REGISTER OF DEEDS IN AND FOR WALWORTH COUNTY, WISCONSIN IN VOL. 5 OF PLATS ON PAGE 242. ALL OF WHICH IS DESCRIBED AS FOLLOWS, TO-WIT: BEGINNING AT THE SE CORNER OF SAID LOT 3; THENCE N. 33 DEGREES 53' W. ALONG THE NE'LY LINE OF SAID LOT 3, 354.06 FT. MORE OR LESS TO THE SHORE OF DELAVAN LAKE; THENCE SW'LY ALONG THE SHORE OF DELAVAN LAKE 75.3 FT. MORE OR LESS TO THE NW CORNER OF SAID LOT 3; THENCE S. 33 DEGREES 53' E. ALONG THE SW'LY LINE OF SAID LOT 3 AND THE EXTENSION SE'LY OF SAID SW'LY LINE 509.80 FT. TO A POINT ON THE E. LINE OF SAID LOT 6; THENCE N. ALONG THE E. LINE OF SAID LOT 6, 134.01 FT.; THENCE N. 89 DEGREES 55' W. 37.50 FT.; THENCE N. 22.52 FT.; THENCE S. 89 DEGREES 55' E. 37.50 FT.; THENCE N. 23.27 FT. TO THE NE CORNER OF SAID LOT 6; THENCE S. 56 DEGREES 07' W. ALONG THE NW'LY LINE OF SAID LOT 6, 25.35 FT. TO THE PLACE OF BEGINNING. ALSO THE FRAME BUILDING OCCUPIED BY THE PARTY OF THE FIRST PART FOR STORAGE OF FIRE EQUIPMENT, WITH THE LAND ON WHICH IT IS BUILT, LOCATED ON PART OF LOTS 4.5 AND 6 OF METTOWEE SUBDIVISION IN THE TOWN OF DELAVAN, WITH RIGHTS OF INGRESS AND EGRESS THERETO.

MORE PARTICULARLY DESCRIBED AS FOLLOWS: BEGINNING AT THE SOUTHEAST CORNER OF SAID LOT 3; THENCE N 57°46'35" E ALONG THE NORTHWESTERLY LINE OF SAID LOT 6, 25.35 FEET TO THE NORTHEAST CORNER OF SAID LOT 6 AND THE WEST LINE OF SOUTH SHORE DRIVE; THENCE S 0°03'09" E ALONG THE WEST LINE OF SAID SOUTH SHORE DRIVE 179.80 FEET TO A POINT THAT IS AN EXTENSION SOUTHEASTERLY OF THE SOUTHWESTERLY LINE OF SAID LOT 3; THENCE N 33°53'00" W ALONG SAID EXTENSION AND SOUTHWESTERLY LINE OF SAID LOT 3, 509.00 FEET MORE OR LESS TO THE NORTHWEST CORNER OF SAID LOT 3 AND THE SHORE OF DELAVAN LAKE; THENCE NORTHEASTERLY ALONG THE SHORE OF SAID DELAVAN LAKE 75.20 FEET MORE OR LESS TO THE NORTHEAST CORNER OF SAID LOT 3 AND A POINT THAT IS N 33°50'24" W 353.77 FEET MORE OR LESS FROM THE PLACE OF BEGINNING; THENCE S 33°50'24" E ALONG THE NORTHEASTERLY LINE OF SAID LOT 3, 353.77 FEET MORE OR LESS TO THE SOUTHEAST CORNER OF SAID LOT 3 AND THE PLACE OF BEGINNING.

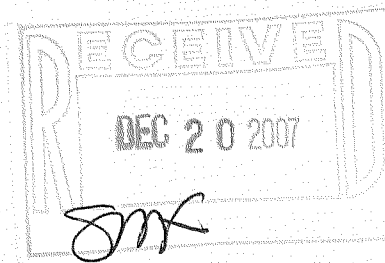
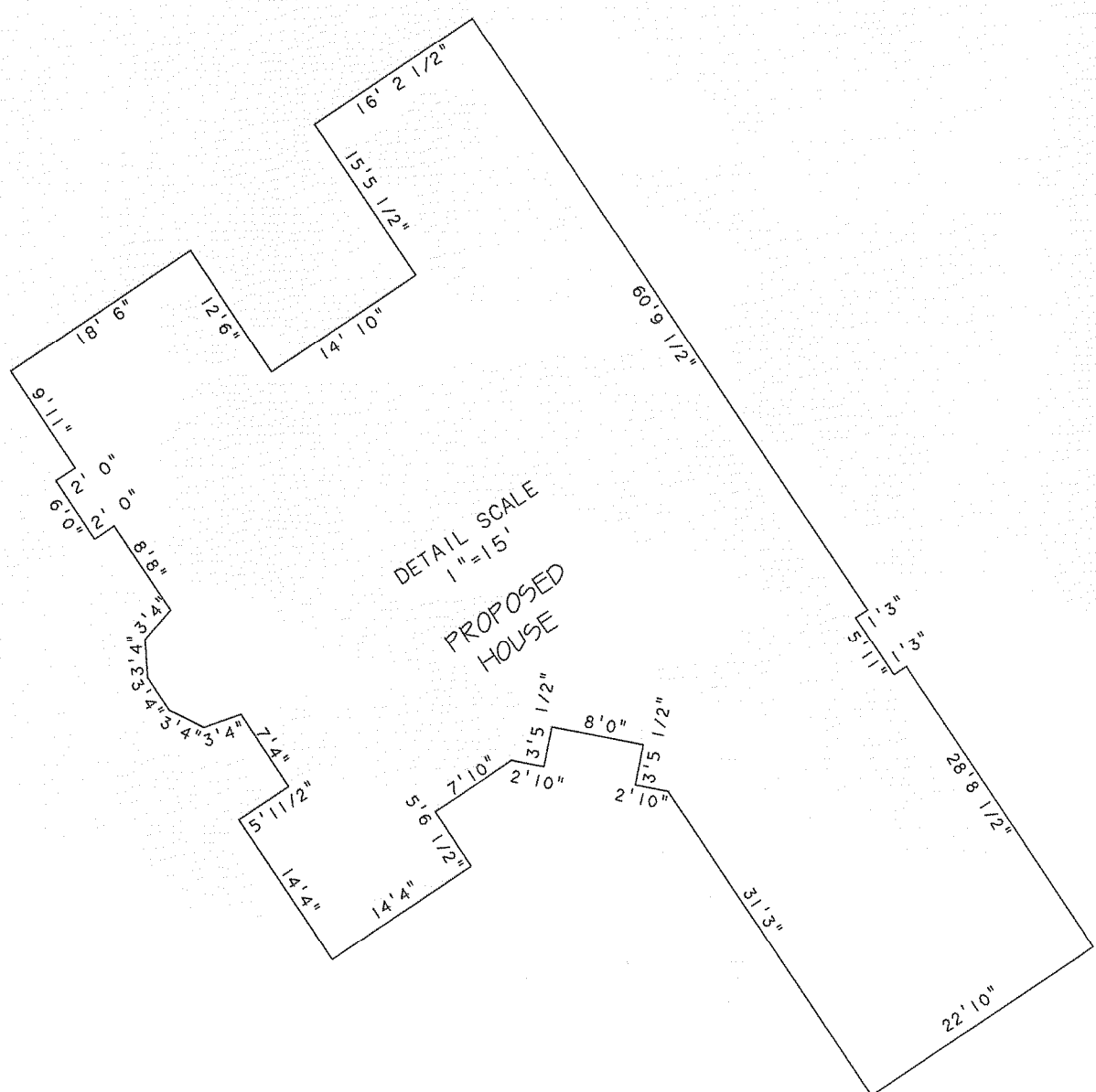

REVISED DATE: JULY 5, 2007
REVISED TO SHOW PROPOSED HOUSE
AND DRIVEWAY LOCATION.

ORDERED BY: JIM VONDRASEK
133 S. SPRING AVENUE
LA GRANGE, IL 60525

I HEREBY CERTIFY THAT I HAVE SURVEYED THE ABOVE DESCRIBED PROPERTY AND THAT THE ABOVE MAP IS A TRUE REPRESENTATION THEREOF AND SHOWS THE SIZE AND LOCATION OF THE PROPERTY, ITS EXTERIOR BOUNDARIES, THE LOCATION OF ALL VISIBLE STRUCTURES AND DIMENSIONS OF ALL PRINCIPAL BUILDINGS THEREON, BOUNDARY FENCES, APPARENT EASEMENTS, ROADWAYS AND VISIBLE ENCROACHMENTS, IF ANY, TO THE BEST OF MY KNOWLEDGE AND BELIEF.

THIS SURVEY IS MADE FOR THE USE OF THE PRESENT OWNERS OF THE PROPERTY, AND ALSO THOSE WHO PURCHASE, MORTGAGE, OR GUARANTEE THE TITLE THERETO WITHIN ONE (1) YEAR FROM DATE HEREON.

David F. Abell
DAVID F. ABELL
WISCONSIN REGISTERED LAND SURVEYOR. S-1596

March 28, 2007

DATE: JOB NUMBER - 92176C
NOTE: THIS IS NOT A CERTIFIED COPY UNLESS SEALED.

SOUTH SHORE DRIVE

955|9
956|5
957|2
958|0
959|1
960|2
961|3
962|6

SILT FENCE TO FOLLOW
EXTERIOR BOUNDARY OF
ENTIRE PROPERTY